

Floor Plan

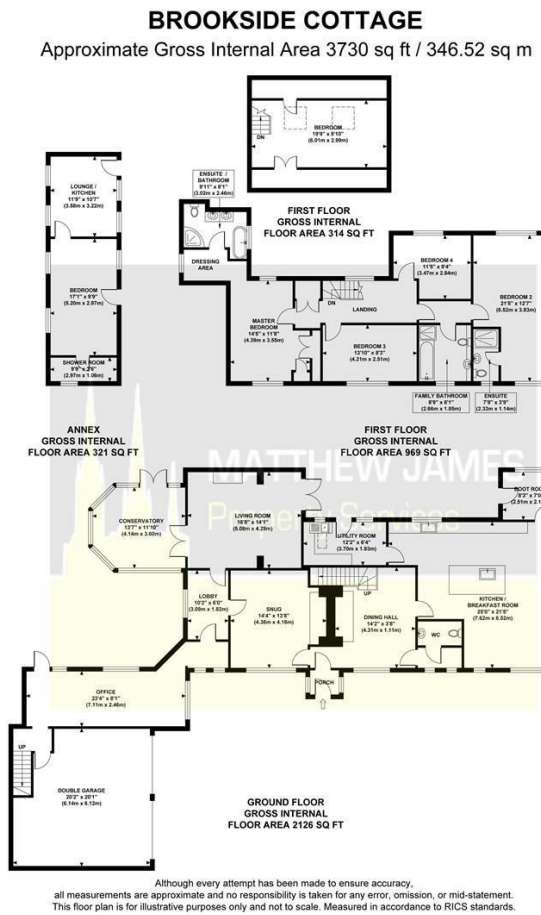

Area Map

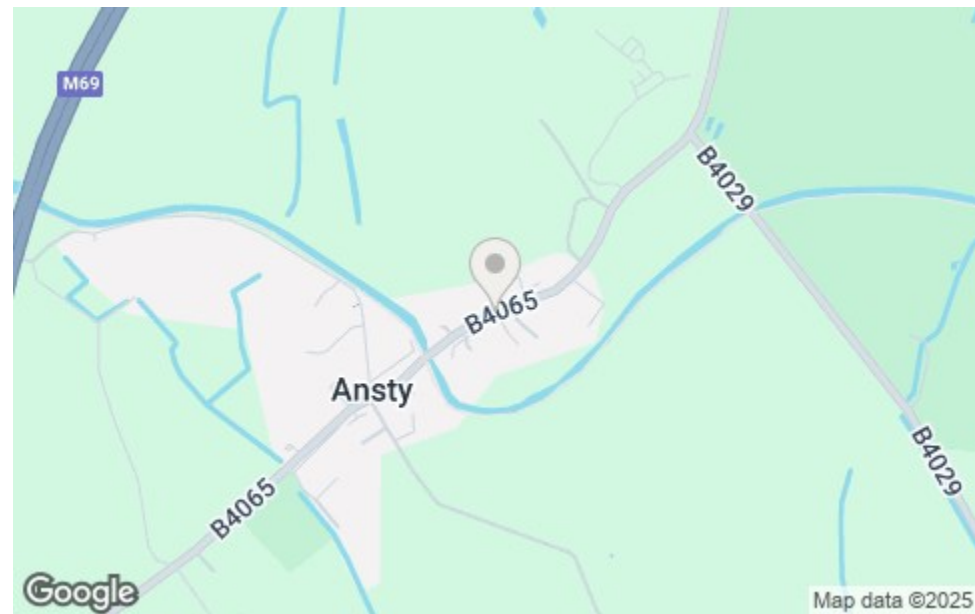

Viewing

Please contact us on 02477 170170 if you wish to arrange a viewing appointment for this property or require further information.

These particulars, whilst believed to be accurate are set out as a general outline only for guidance and do not constitute any part of an offer or contract. Intending purchasers should not rely on them as statements of representation of fact, but must satisfy themselves by inspection or otherwise as to their accuracy. No person in this firm's employment has the authority to make or give any representation or warranty in respect of the property.

CONTACT INFORMATION

24a Warwick Row, Coventry CV1 1EY

02477 170170

info@matthewjames.uk.com

www.matthewjames.uk.com

Facebook

Twitter

MATTHEW JAMES
Property Services

Energy Efficiency Graphs

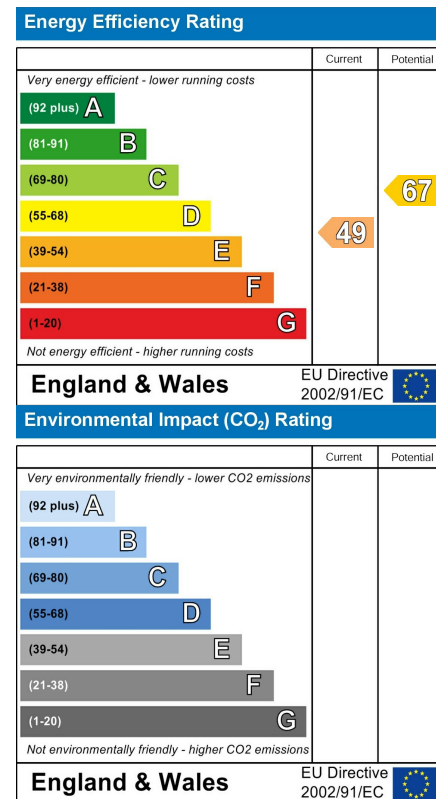

Brookside Cottage Main Road

Ansty, Coventry CV7 9JA

£900,000





Description

Charming six -bedroom cottage with annex situated within the idyllic Ansty village This beautifully restored and extended detached cottage offers an abundance of space, character, and versatility. Perfect for modern family living with an inviting blend of comfort and elegance in a peaceful semi-rural setting.

The property boasts: Entrance porch, through to the dining hall featuring beautiful fireplace, visible beams, from this room you can access both wings of the cottage. Ground floor W.C, through to the heart of the home, the impressive kitchen/breakfast room, designed for both functionality and style offering a large range of units, granite work surfaces, central chef island, tv/seating area, adjoining utility room and boot room for added convenience. To the other wing, cosy snug with inglenook fireplace, lobby leading into the spacious living room and conservatory. Back through the lobby into the home office, ideal for remote working or hobby enthusiasts with direct access into the garage. To the first floor, four bedrooms and family bathroom. The master bedroom features a private

- EXTENDED AND REMODELED DETACHED COTTAGE
- FOUR RECEPTION ROOMS
- LARGE KITCHEN/BREAKFAST ROOM
- SEPERATE ANNEX
- WRAP AROUND GARDEN
- SIX BEDROOMS
- FOUR BATHROOMS INCLUDING TWO EN-SUITES
- SPACIOUS OFFICE
- DOUBLE GARAGE/ LARGE DRIVEWAY
- HIGH SPECIFICATION THROUGHOUT

